

# Summerhill Residential Aged Care



Clayton Church Homes Summerhill is set amongst beautiful gardens overlooking the Uraidla township and fertile Piccadilly Valley.

**Our Summerhill residence offers a comfortable, respectful and loving home in an idyllic rural setting.**

#### Features

- 25 spacious single rooms with private ensuite
- Beautiful gardens
- Numerous quiet and comfortable lounge areas with large-screen televisions
- Activity room with expansive views of the hills

- Communal dining room
- Smaller sitting room available for birthdays and special events
- Undercover outdoor patio area
- Permanent care
- Short-term respite care

#### Lifestyle and services

- Nutritious home-style meals freshly prepared and cooked on site
- Stimulating lifestyle and activities program

- Library service
- Pastoral care support as required

Additional land has been purchased around the facility with the intent to redevelop and expand to 60 beds.

#### Please Note

Site maps and floor plans show typical approximate layouts. The exact floor plan of each residence is available upon request.

## Be you.

To learn more about our properties or to arrange a tour, call 8404 8200.

[claytonhomes.com.au](http://claytonhomes.com.au)

  
Clayton Church Homes

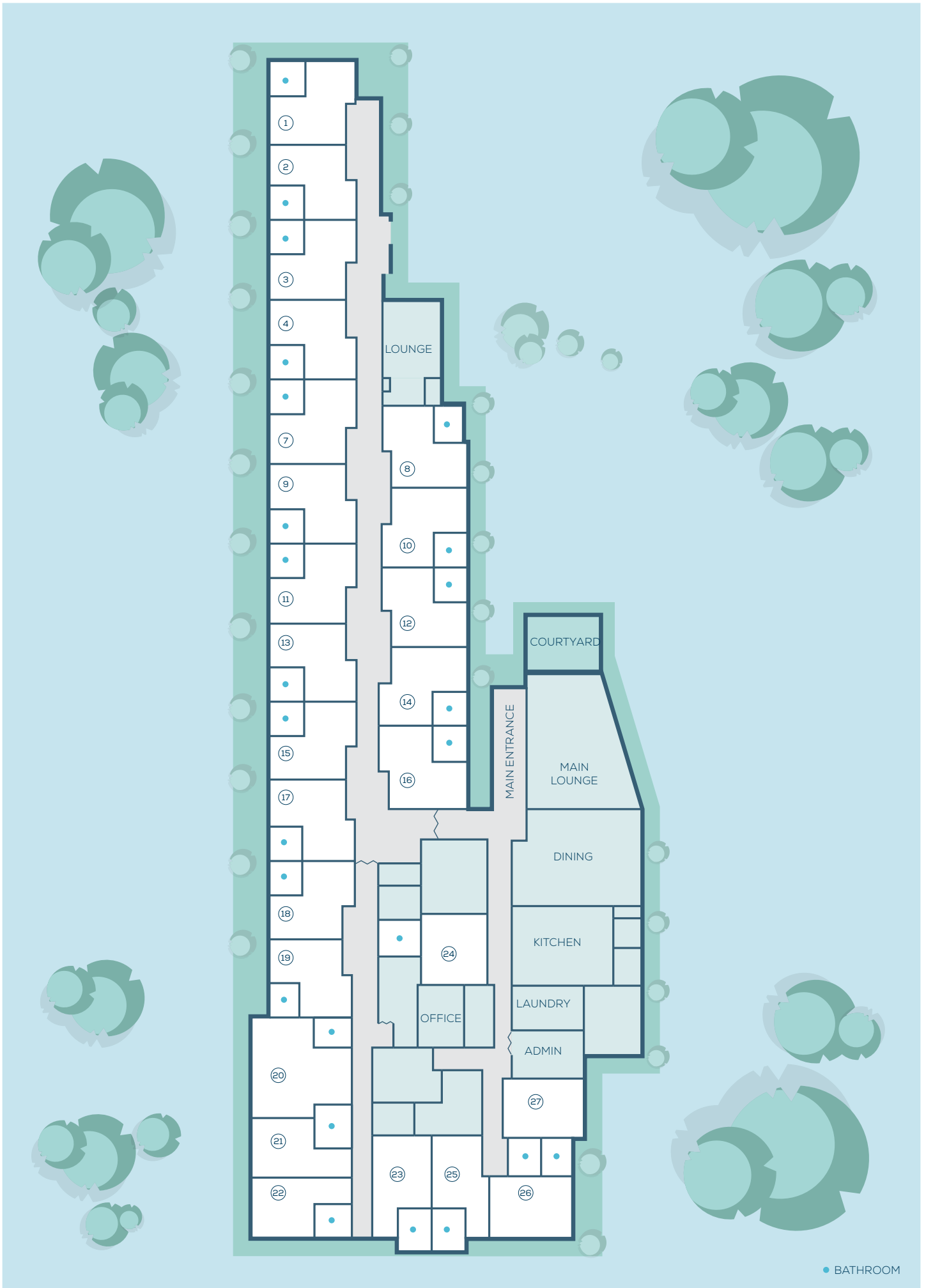

● BATHROOM

Summerhill Residential Aged Care Site Map